



Applications:

Facade, Wall Washing, Landscape lighting, Poster board lighting, Building lighting.

Features

- The one piece die-cast aluminum housing with UV resistant polycarbonate optical lens, outstanding corrosion protection.
- Lumen output 21000-51000lm with efficacy to 146lm/W
- Available with wall mount or trunnion(YOKE) or slipfitter mounting kit
- Increase energy savings with photocell.
- Voltage is 120-277V / 347V-480V and support 0-10V dimmable
- Suitable for use in ambients from -40°C to 45 °C (-40 °F to 113 °F)
- Expected service life is over 100,000 hrs and 5 year limited warranty
- UL Wet location and DLC premium listed



Medium Size: 150W/200W

Large Size: 250W/300W/350W

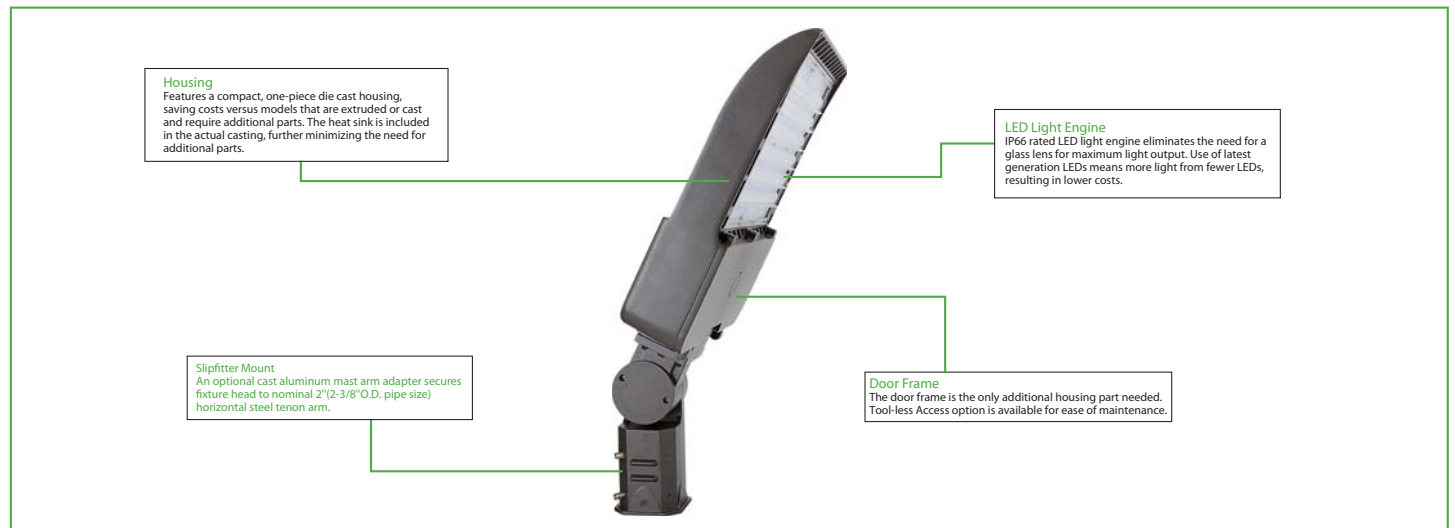

PERFORMANCE DATA

SYSTEM WATTS	VOLTAGE	DIST. TYPE	4000K(70CRI)		5000K(70CRI)	
			LUMENS	LPW	LUMENS	LPW
150W	120-277V	7Hx7V	21000lm	140 lm/W	21150lm	141 lm/W
200W	120-277V	7Hx7V	27000lm	135 lm/W	27200lm	136 lm/W
250W	120-277V	7Hx7V	35000lm	140 lm/W	35250lm	141 lm/W
300W	120-277V	7Hx7V	42000lm	140 lm/W	42300lm	141 lm/W
350W	120-277V	7Hx7V	51000lm	146 lm/W	51000lm	146 lm/W

ELECTRICAL DATA

Number Of Drivers	Driver Current (mA)	Nominal Power (W)	INPUT VOLTAGE (V)	CURRENT (Amps)
1	3900	150	120	1.25
		150	208	0.72
		150	240	0.63
		150	277	0.54
		150	347	0.43
		150	480	0.31
1	5100	200	120	1.25
		200	208	0.72
		200	240	0.63
		200	277	0.54
		200	347	0.43
		200	480	0.31
1	6400	250	120	1.25
		250	208	0.72
		250	240	0.63
		250	277	0.54
		250	347	0.43
		250	480	0.31
1	6000	300	120	1.25
		300	208	0.72
		300	240	0.63
		300	277	0.54
		300	347	0.43
		300	480	0.31
1	6200	350	120	1.25
		350	208	0.72
		350	240	0.63
		350	277	0.54
		350	347	0.43
		350	480	0.31

DIMENSION

unit: inch/mm

Slipfitter Mount(150W&200W)

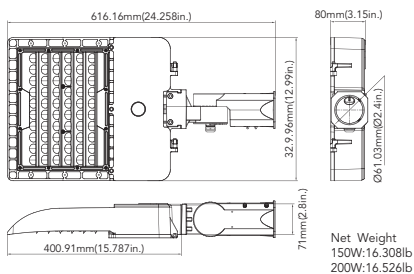

Wall Mount(150W&200W)

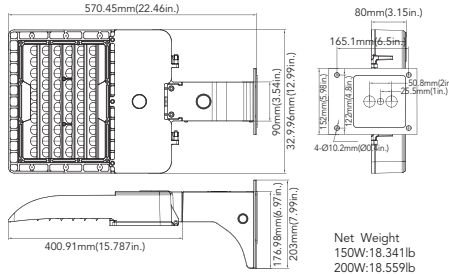

Yoke Mount(150W&200W)

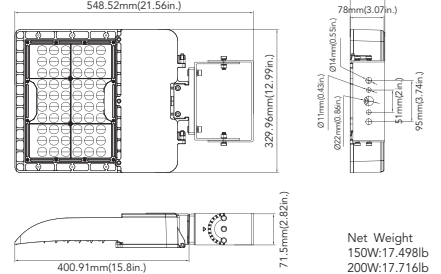

Slipfitter Mount(250W&300W&350W)

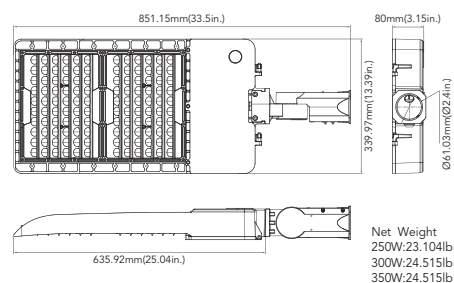

Wall Mount(250W&300W&350W)

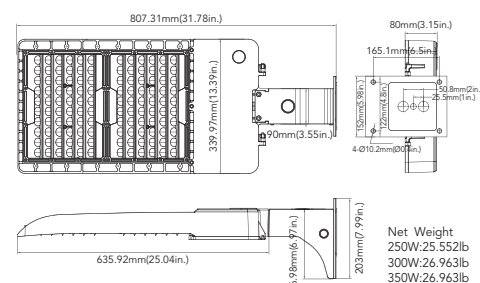

Trunnion Mount(250W&300W&350W)

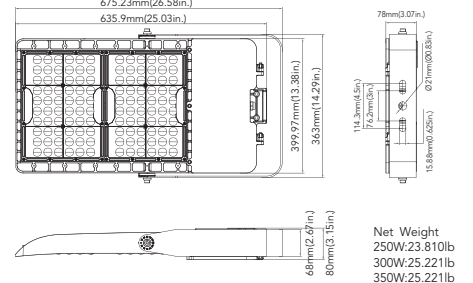

MOUNTING

- Heavy duty aluminum trunnion easily adapted to many surfaces and allows easy fixture aiming angles.
- Wall Mount available for direct wall mounting and J-box mounting
- Optional for cast aluminum slipfitter mounting adapter

Mounting Options



Slipfitter Mount
An optional cast aluminum mast arm adapter secures fixture head to nominal 2"(2-3/8" O.D. pipe size) horizontal steel tenon arm.



Trunnion(Yoke) Mount
Die-cast aluminum trunnion is easily adapted to many surfaces and allows easy fixture aiming angles.



Wall Mount
Wall Mount is easy to install for direct wall mounting with 1/2' conduit wiring or standard J-box mounting

PHOTOMETRICS

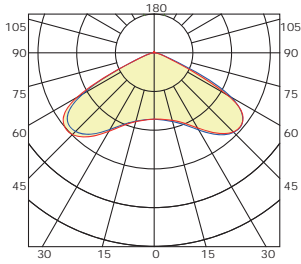

ORDERING GUIDE

Example: MFD05 150W 27V XXK Y Y Y Y Y

Fixture Type	Wattage	Voltage	CCT	CRI	Finish	Photocell (Option)	NEMA	Mounting
<input type="text"/>	<input type="text"/>	<input type="text"/>	<input type="text"/>	<input type="text"/>	<input type="text"/>	<input type="text"/>	<input type="text"/>	<input type="text"/>
MFD05 Flood Light	150 150W 200 200W 250 250W 300 300W 350 350W	27V 120-277V 48V 347-480V	40K 4000K 50K 5000K	B 70CRI	D Dark Bronze B Black W White SG Silver Gray	P0 120-277V Photocell P3 347V Photocell P4 480V Photocell Blank Without Photocell	B77 7Hx7V	TR Trunnion Mount SP Slipfitter Mount WM Wall Mount YK Yoke Mount

Note: 1. Input voltage may vary depends on photocell(sensor) configuration
2.The Yoke Mount only suitable for the medium size, and the trunnion only suitable for the large size.

ADDITIONAL MOUNTING ACCESSORIES

POLE BRACKET • For mounting one fixture on an existing pole

	<p>4" Square Pole Mount with 2-3/8" O.D. Tenon No. 4SQ-SP-D Finish: Dark Bronze USE: For use with square, non-tapered steel and aluminum poles. Furnished with four 5/16" hex head stainless-steel bolts. Vertical tenon measures 2-3/8" O.D., and is made of steel tubing. Fixtures mounted to this bracket can be adjusted both vertically and horizontally.</p>		<p>4" Round Pole Mount with 2-3/8" O.D. Tenon NO. 45QR-SP-D Finish: Dark Bronze USE: For use with round, non-tapered steel and aluminum poles. Furnished with three 3/8" hex head stainless-steel bolts. Vertical tenon measures 2-3/8" O.D., and is made of steel tubing. Fixtures mounted to this bracket can be adjusted both vertically and horizontally.</p>
	<p>5" Square Pole Mount with 2-3/8" O.D. Tenon No. 5SQ-SP-D Finish: Dark Bronze USE: For use with square, non-tapered steel and aluminum poles. Furnished with four 5/16" hex head stainless-steel bolts. Vertical tenon measures 2-3/8" O.D., and is made of steel tubing. Fixtures mounted to this bracket can be adjusted both vertically and horizontally.</p>		<p>5" Round Pole Mount with 2-3/8" O.D. Tenon NO. 55QR-SP-D Finish: Dark Bronze USE: For use with round, non-tapered steel and aluminum poles. Furnished with three 3/8" hex head stainless-steel bolts. Vertical tenon measures 2-3/8" O.D., and is made of steel tubing. Fixtures mounted to this bracket can be adjusted both vertically and horizontally.</p>
	<p>Pole Bracket accessories-Tenon & Yoke Adaptor NO. SP-TR-D Finish: Dark Bronze USE: The 2-3/8" OD Tenon Mount Adaptor for Yoke Fixtures is designed to mount MESTER light fixtures that are equipped with a yoke mount onto a 2-3/8" OD tenon. It may be utilized with the Mester Flood Light Series of light fixtures.</p>		

ADDITIONAL MOUNTING ACCESSORIES

WALL BRACKET		Mid-Pole tenon Bracket	
	<ul style="list-style-type: none"> Attaches to any flat surface Provides wiring access <p>90° Wall Mount Bracket with 2-3/8" O.D. Tenon NO. WM-SP-D Finish: Dark Bronze USE: The 90° wall mount bracket with 2-3/8" tenon attaches an MESTER floodlight to almost any surface: wall, roof, or wood pole. Provides wiring access and abuilt-in 2-3/8" O.D. tenon to mount a fixture with our adjustable slipfitter. Suggested 3/8" diameter bolts for mounting. Mounting holes are spaced 3-1/4" apart.</p>		<p>2-3/8" OD Horizontal Tenon Mid-Pole Bracket NO. SQ-SP-D Finish: Dark Bronze USE: 2-3/8" OD Horizontal Tenon Mid-Pole Bracket is designed to mount light fixture that is equipped with a adjustable slipfitter onto a 2-3/8" OD horizontal tenon</p>
Round External Mount Horizontal Tenon - To mount 2/3/4 fixtures on a existing pole			
	<p>Double 90° Horizontal Tenon Adaptor NO. R60-SP2-90-D Finish: Dark Bronze USE: The Bracket is designed to mount over 2-3/8" (60mm) O.D. vertical tenon. Two fixtures can be mounted to the Round External Mount Horizontal Tenon and adjusted horizontally</p>		<p>Triple 120° Horizontal Tenon Adaptor NO. R60-SP3-120-D Finish: Dark Bronze USE: The Bracket is designed to mount over 2-3/8" (60mm) O.D. vertical tenon. Three fixtures can be mounted to the Round External Mount Horizontal Tenon and adjusted horizontally</p>
	<p>Double 180° Horizontal Tenon Adaptor NO. R60-SP2-180-D Finish: Dark Bronze USE: The Bracket is designed to mount over 2-3/8" (60mm) O.D. vertical tenon. Two fixtures can be mounted to the Round External Mount Horizontal Tenon and adjusted horizontally</p>		<p>Quad 90° Horizontal Tenon Adaptor NO. R60-SP4-90-D Finish: Dark Bronze USE: The Bracket is designed to mount over 2-3/8" (60mm) O.D. vertical tenon. Four fixtures can be mounted to the Round External Mount Horizontal Tenon and adjusted horizontally</p>
	<p>Triple 90° Horizontal Tenon Adaptor NO. R60-SP3-90-D Finish: Dark Bronze USE: The Bracket is designed to mount over 2-3/8" (60mm) O.D. vertical tenon. Three fixtures can be mounted to the Round External Mount Horizontal Tenon and adjusted horizontally</p>		

DLC Model NO.

SYSTEM WATTS	VOLTAGE	CCT	NEMA	DLC NO.	DLC Classification
150W	120-277V	4000K	7Hx7V	MFD05150W27V40KB[D,B,W,SG][Blank,P0]B77[TR,SP,WM,YK]	Premium
		5000K	7Hx7V	MFD05150W27V50KB[D,B,W,SG][Blank,P0]B77[TR,SP,WM,YK]	Premium
	347-480V	4000K	7Hx7V	MFD05150W48V40KB[D,B,W,SG][Blank,P3,P4]B77[TR,SP,WM,YK]	Premium
		5000K	7Hx7V	MFD05150W48V50KB[D,B,W,SG][Blank,P3,P4]B77[TR,SP,WM,YK]	Premium
200W	120-277V	4000K	7Hx7V	MFD05200W27V40KB[D,B,W,SG][Blank,P0]B77[TR,SP,WM,YK]	Premium
		5000K	7Hx7V	MFD05200W27V50KB[D,B,W,SG][Blank,P0]B77[TR,SP,WM,YK]	Premium
	347-480V	4000K	7Hx7V	MFD05200W48V40KB[D,B,W,SG][Blank,P3,P4]B77[TR,SP,WM,YK]	Premium
		5000K	7Hx7V	MFD05200W48V50KB[D,B,W,SG][Blank,P3,P4]B77[TR,SP,WM,YK]	Premium
250W	120-277V	4000K	7Hx7V	MFD05250W27V40KB[D,B,W,SG][Blank,P0]B77[TR,SP,WM,YK]	Premium
		5000K	7Hx7V	MFD05250W27V50KB[D,B,W,SG][Blank,P0]B77[TR,SP,WM,YK]	Premium
	347-480V	4000K	7Hx7V	MFD05250W48V40KB[D,B,W,SG][Blank,P3,P4]B77[TR,SP,WM,YK]	Premium
		5000K	7Hx7V	MFD05250W48V50KB[D,B,W,SG][Blank,P3,P4]B77[TR,SP,WM,YK]	Premium
300W	120-277V	4000K	7Hx7V	MFD05300W27V40KB[D,B,W,SG][Blank,P0]B77[TR,SP,WM,YK]	Premium
		5000K	7Hx7V	MFD05300W27V50KB[D,B,W,SG][Blank,P0]B77[TR,SP,WM,YK]	Premium
	347-480V	4000K	7Hx7V	MFD05300W48V40KB[D,B,W,SG][Blank,P3,P4]B77[TR,SP,WM,YK]	Premium
		5000K	7Hx7V	MFD05300W48V50KB[D,B,W,SG][Blank,P3,P4]B77[TR,SP,WM,YK]	Premium